

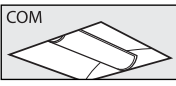

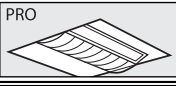
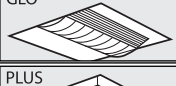

Hi - Style

Hi - Style DAYLITE & Hi - Style SMART

1x 40W, 1 & 2x 55W, 1x 80W PL-L

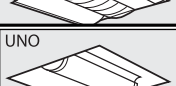
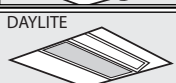
Installation Instructions ● Instructions de Montage ● Montageanweisung ● Istruzioni di Montaggio

	Hi -Style		Hi -Style SMART		kg	
	# 600 x 600	# 625 x 625	# 600 x 600	# 625 x 625		
COM 	HI 12292 HI 12563 HI 12293	HI 12725 - HI 12726	HI 12295D HI 12594D HI 12296D	HI 12727D - HI 12728D	1 x 55W 2 x 55W 1 x 80W	5.2 5.3 5.2
PRO 	HI 12303 HI 12304	HI 12733 HI 12734	HI 12305D HI 12306D	HI 12735D HI 12736D	1 x 40W 1 x 55W	5.0 5.0
GLO 	HI 12319 HI 12320	HI 12737 HI 12738	HI 12323D HI 12324D	HI 12739D HI 12740D	1 x 40W 1 x 55W	4.9 4.9
PLUS 	HI 12333 HI 12334	HI 12741 HI 12742	HI 12337D HI 12338D	HI 12743D HI 12744D	1 x 40W 1 x 55W	6.3 6.3
PERFORMER 	HI 12393 HI 12394	HI 12745 HI 12746	HI 12397D HI 12398D	HI 12747D HI 12748D	1 x 40W 1 x 55W	6.7 6.7
UNO 	HI 12298 HI 12299	HI 12729 HI 12730	HI 12301D HI 12302D	HI 12731D HI 12732D	1 x 55W 1 x 80W	5.6 5.6
DAYLITE 	HI 12996 HI 12997	HI 13261 HI 12730	- -	- -	1 x 55W 2 x 40W	5.9 5.9

EHI 12292 etc. =  IP 20 **CE**

THI 12292 etc. = **AutoTest**

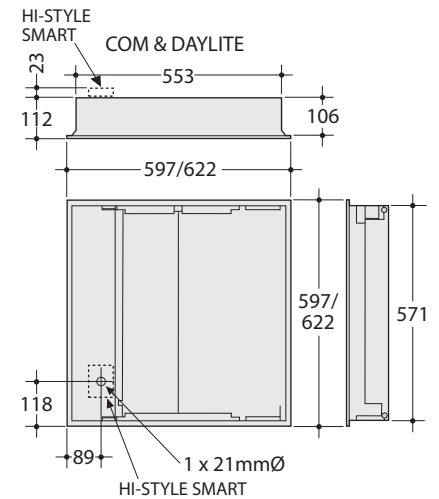

MOUNTING METHODS - Méthodes de support - Montagemethoden - Metodi del montaggio

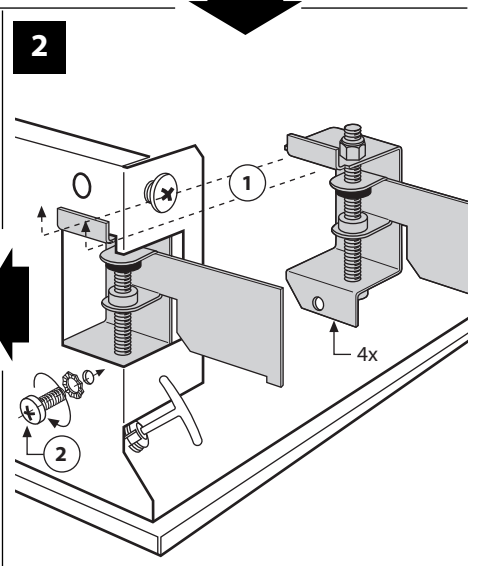
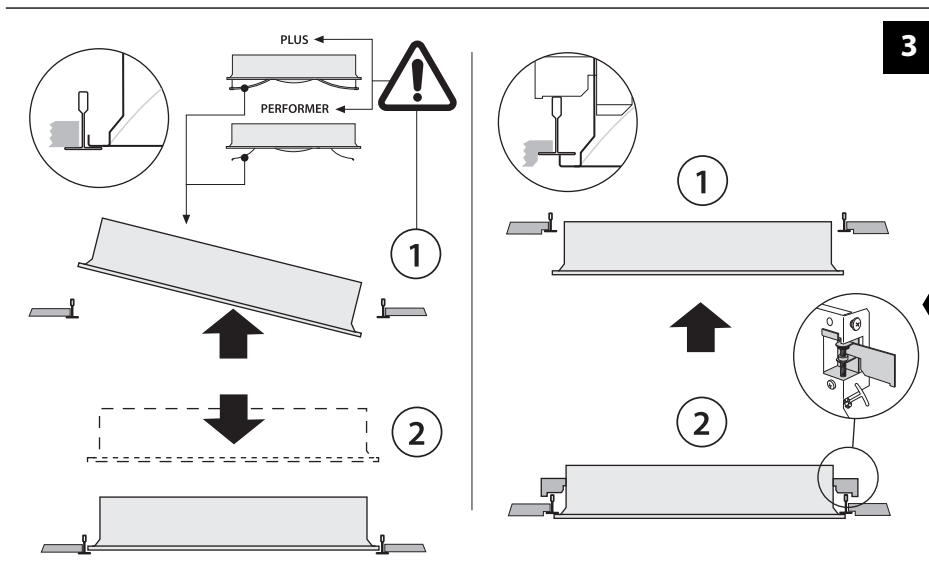
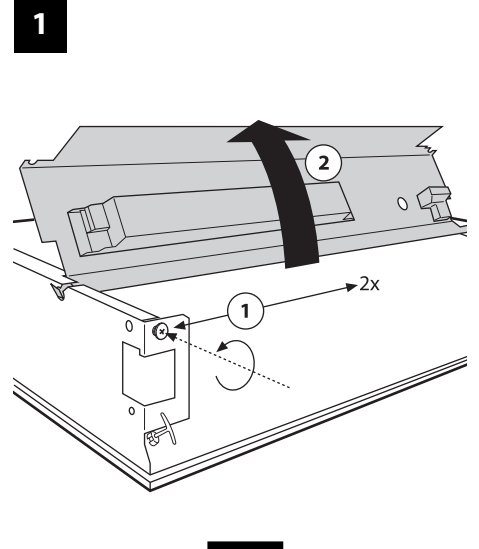
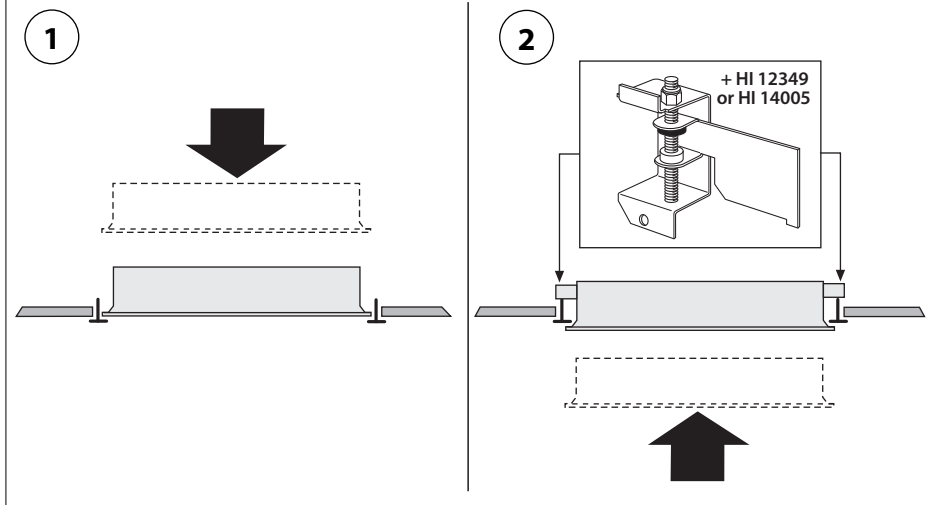

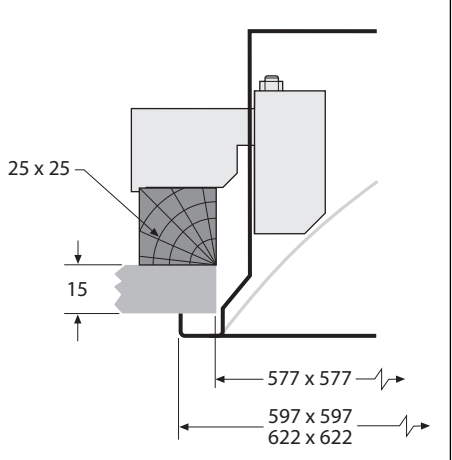
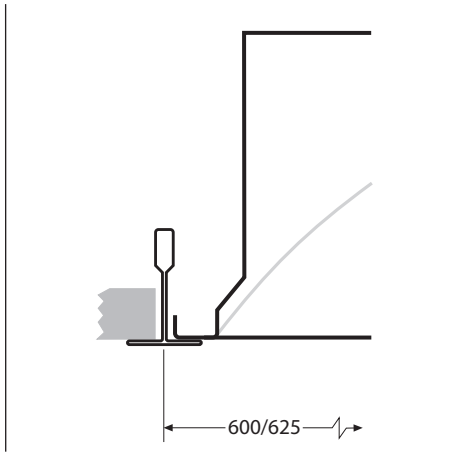
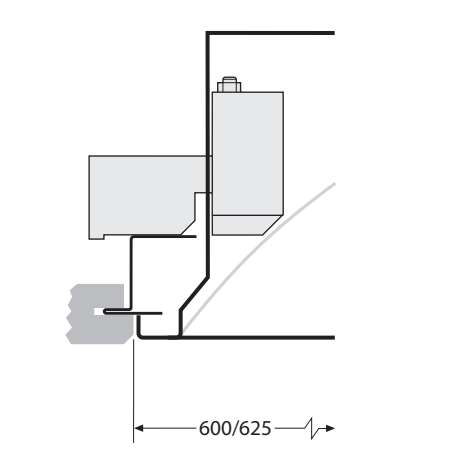
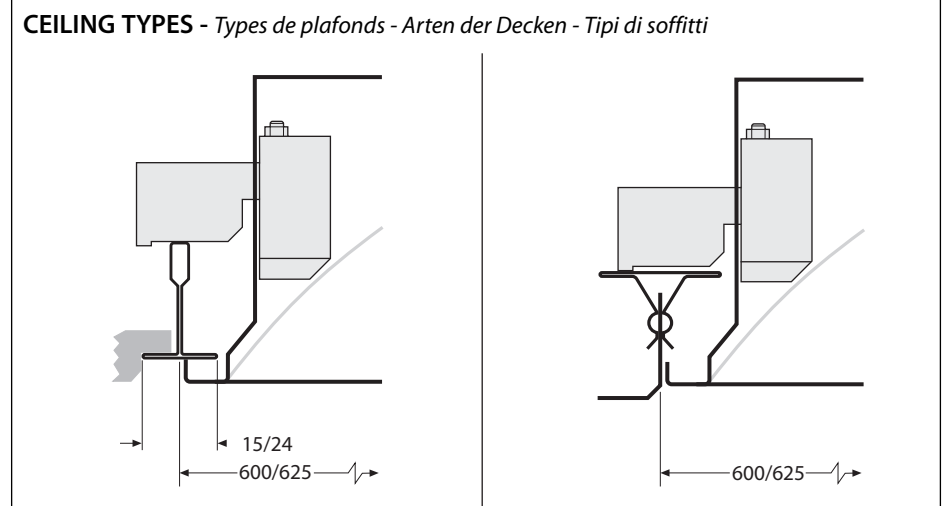
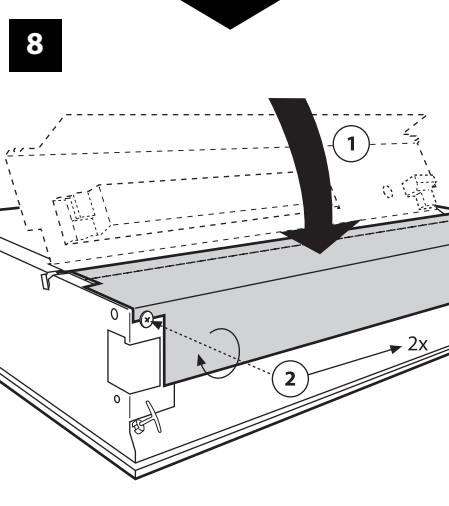
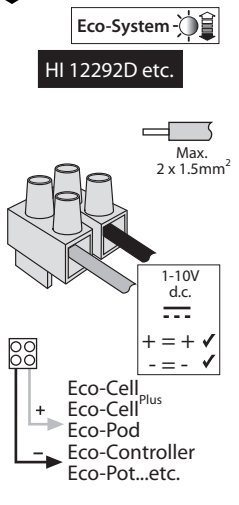
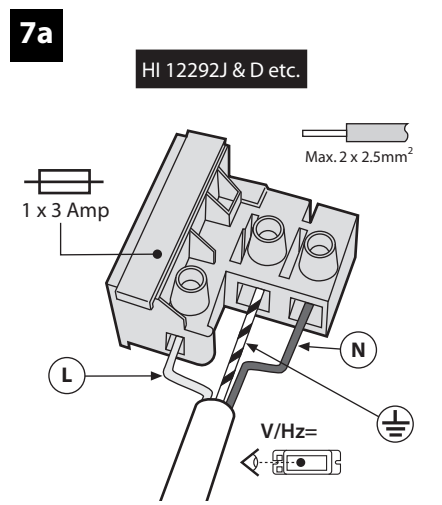
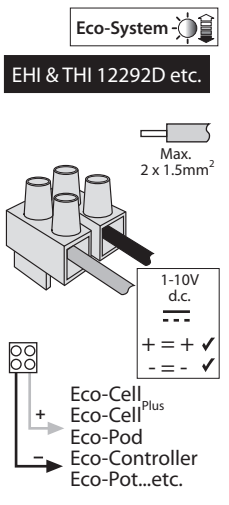
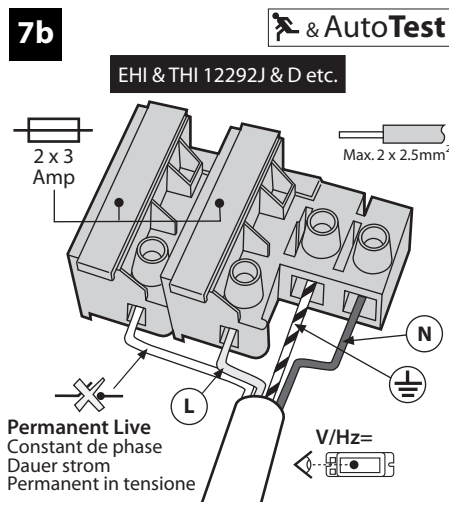
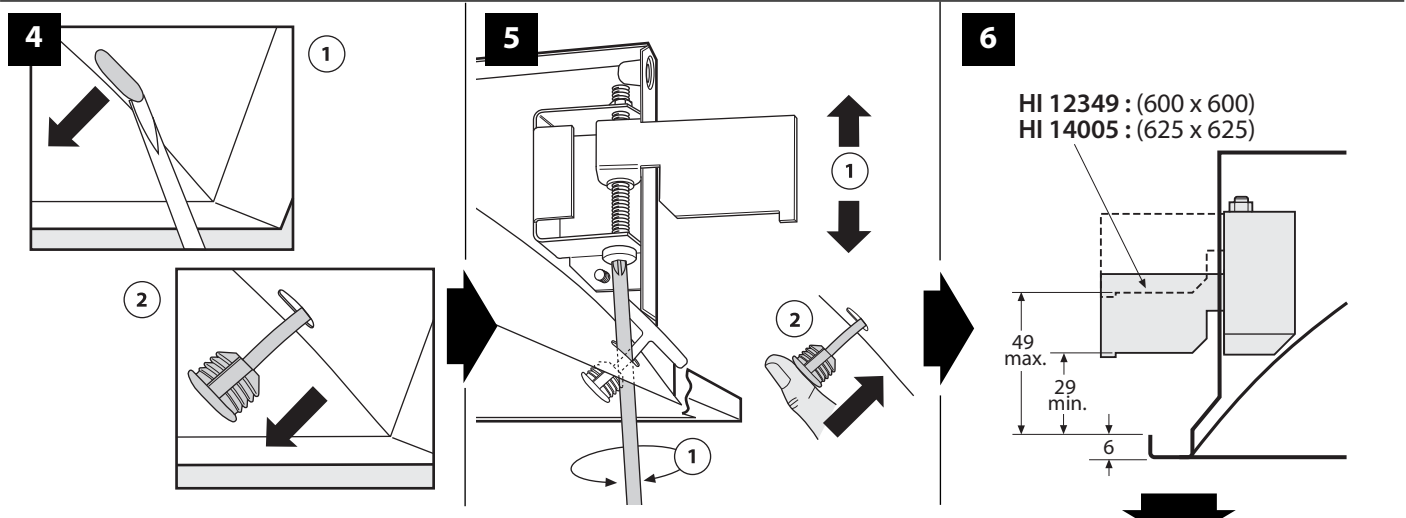

REPLACING THE LAMP - Remplacement de la lampe - Ersetzen der Lampe - Sostituzione della lampada

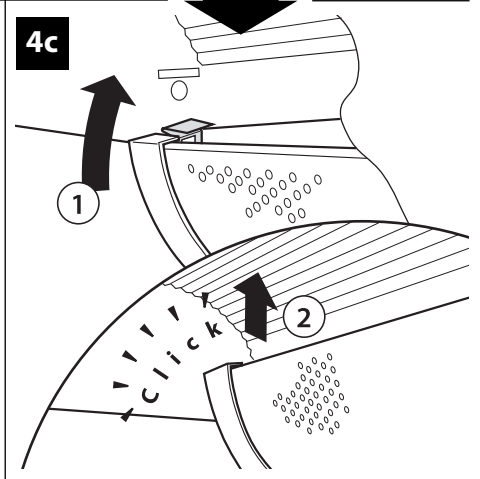
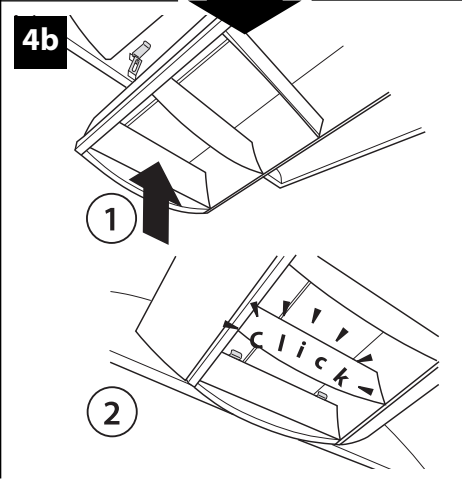
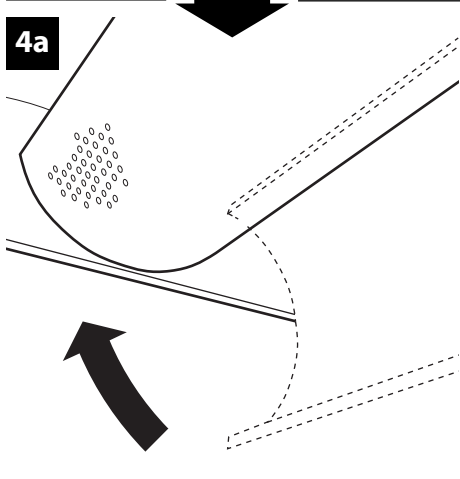
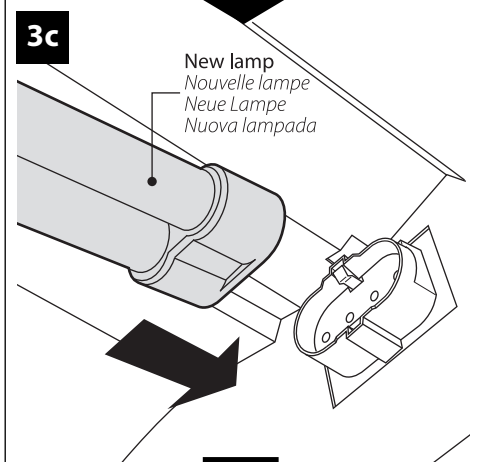
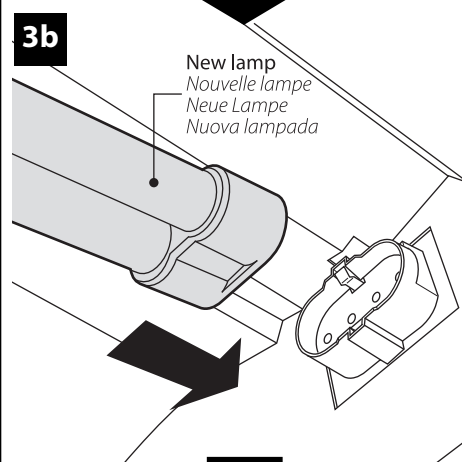
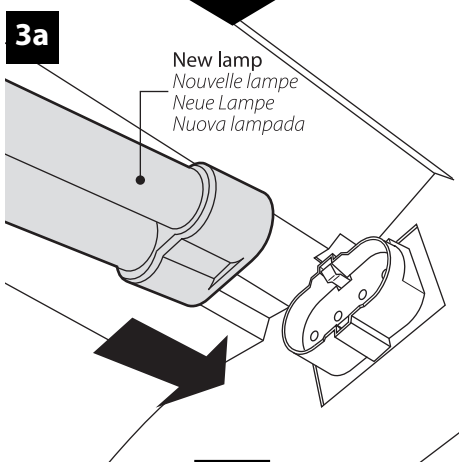
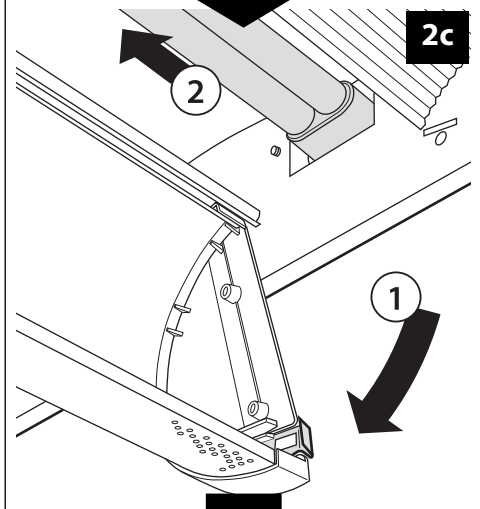
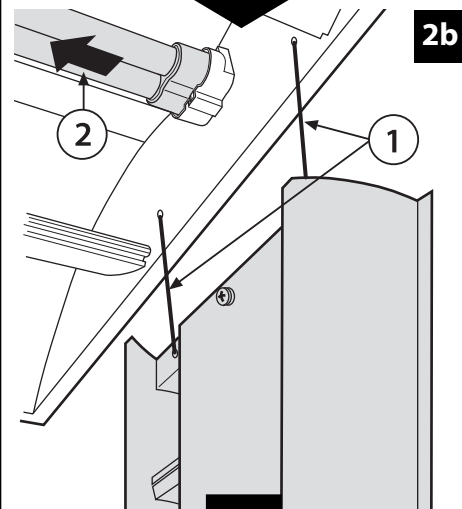
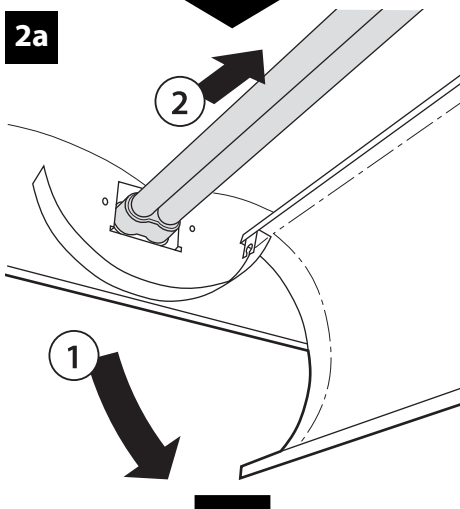
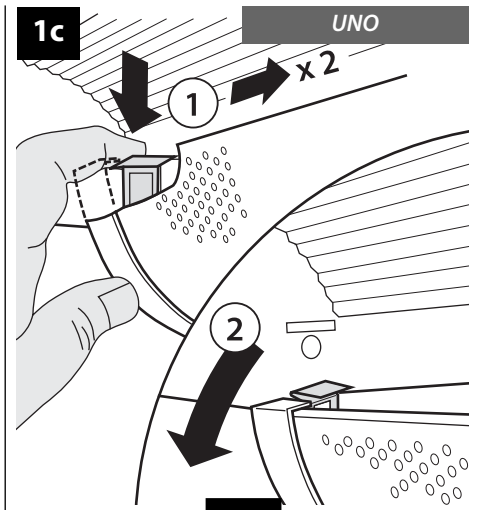
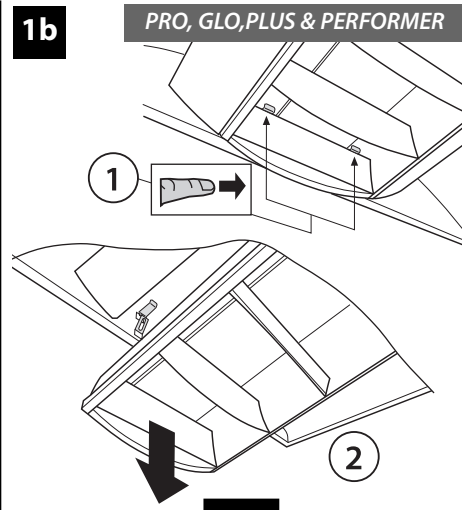
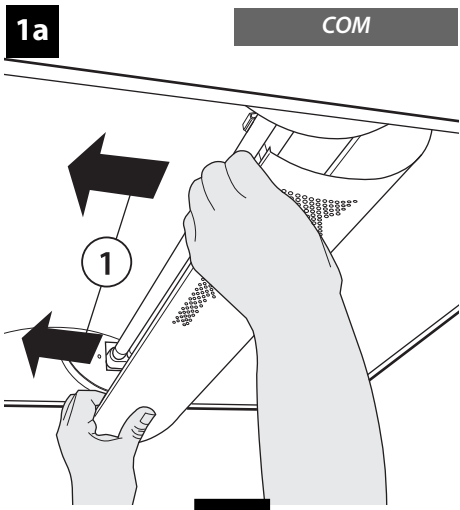

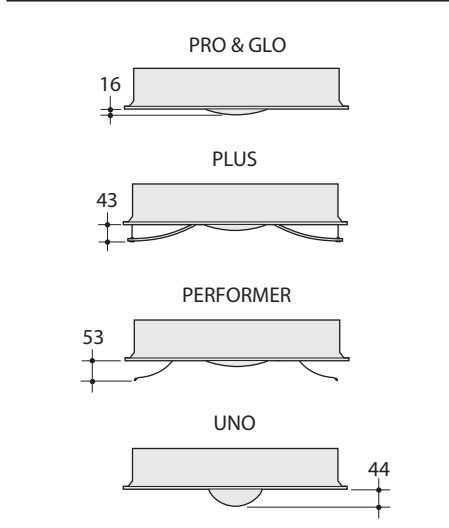
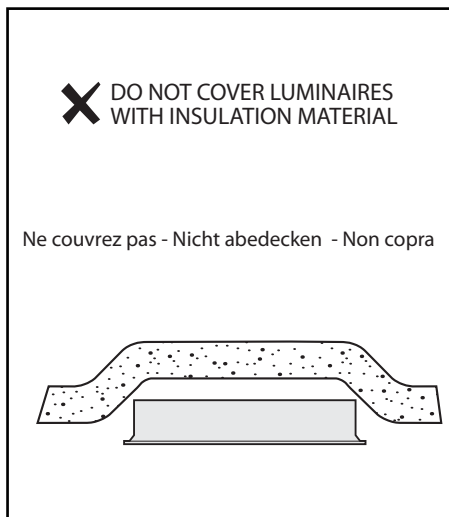
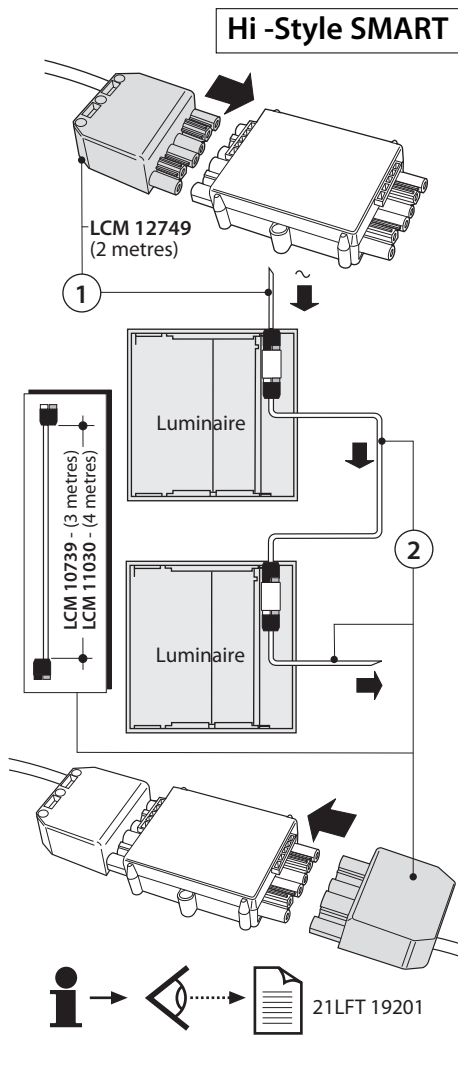

Operation and Maintenance

Failed lamps should be replaced promptly or the circuit switched off to avoid possible damage to control gear. Continual operation at mains voltages in excess of the rated voltage will reduce lamp and expected gear life.

The Hi-Style uses plastic components in its construction and when installed in environments containing chemicals, degradation may occur.

Please contact our Technical Department for advice.

Modifications

Thorlux products should not be modified. Any modification may render the product unsafe and will invalidate any Safety/Approval marks. Thorlux will not accept any responsibility for any modified products or for any damage caused as a result of their modification.

Fonctionnement et Maintenance

Les lampes défectueuses doivent être changées rapidement ou le circuit doit être coupé pour éviter tout risque d'endommagement de l'appareil de commande. Un fonctionnement continu à des tensions secteur dépassant la tension nominale réduira la durée de vie prévue de la lampe et de l'appareil de commande.

Des composants en plastique ont été intégrés dans la construction du Hi-Style et une certaine détérioration peut survenir lorsqu'il est installé dans des environnements contenant des produits chimiques.

Veillez contacter notre Département Technique pour obtenir de plus amples informations.

Modifications

Les produits Thorlux ne doivent pas être modifiés. Toute modification peut compromettre la sécurité du produit et annuler les marques de sécurité / homologation. Thorlux refusera toute responsabilité pour des produits modifiés ou pour tout dommage entraîné par une modification.

Betrieb und Wartung

Um eine Beschädigung des Vorschaltgeräts zu vermeiden, sollten defekte Lampen unverzüglich ausgewechselt oder der Stromkreis unterbrochen werden.

Bei fortlaufendem Betrieb mit einer Netzspannung, die die Nennspannung übersteigt, nimmt die erwartete Lebensdauer der Lampe und des Geräts ab.

Hi-Style-Produkte enthalten Kunststoffteile; bei einer Installation in Umgebungen, die Chemikalien enthalten, ist ein Qualitätsverlust nicht auszuschließen. Unsere Technische Abteilung berät Sie gerne.

Änderungen

Thorlux-Produkte sollten nicht geändert werden. Jegliche Änderungen können die Produktsicherheit beeinträchtigen und machen Sicherheits-/Genehmigungskennzeichnungen ungültig. Thorlux übernimmt keine Verantwortung für modifizierte Produkte bzw. für Schäden, die durch Produktänderungen verursacht werden.

Funzionamento e manutenzione

Quando le lampadine si guastano, sostituirle immediatamente. oppure spegnere il circuito per evitare danni possibili all'ingranaggio di comando. Una tensione continuamente in eccesso di quella stipulata farà ridurre l'anticipata vita della lampadina e dell'ingranaggio.

Il Hi-Style è stato costruito con componenti di plastica e, se installato in ambienti che contengono sostanze chimiche, si può notare un degradamento. Per ulteriori consigli si prega di contattare il nostro reparto tecnico.

Modifiche

I prodotti Thorlux non devono essere modificati, dato che qualsiasi modifica potrebbe rendere il prodotto insicuro e invalidare ogni segno di sicurezza/approvazione. Thorlux non accetta nessuna responsabilità per prodotti modificati e per danni causati quale risultato delle modifiche apportate agli stessi.

Important-Safety

Before carrying out any servicing on this luminaire, ensure that the mains supply is fully isolated.

Disconnect luminaire before insulation testing of the installation.

Important-Sécurité

Avant d'effectuer des réparations sur ce luminaire, vérifiez que l'alimentation secteur est coupée.

Débranchez le luminaire avant d'effectuer un essai d'isolement de l'installation.

Wichtiger Sicherheitshinweis

Stellen Sie vor Durchführen von Wartungsarbeiten an diesem Beleuchtungskörper sicher, dass die Netzstromversorgung vollständig isoliert ist.

Trennen Sie den Beleuchtungskörper von der Stromversorgung, bevor Sie die Isolierung der Anlage testen.

Importante - Sicurezza

Prima di eseguire la manutenzione, assicurarsi che la rete elettrica sia completamente isolata.

Scollegare il prodotto prima di eseguire il test d'isolamento dell'installazione.



Deutschland: www.thorlux.de

Sverige: www.thorlux.se

Ireland: www.thorlux.ie

Australia: www.thorlux.com.au

+49 (0)89 31881794

+46 (0)46 771783

+353 (0)1 460 4608

+61 (0)3 9338 1891

MERSE ROAD NORTH MOONS MOAT
REDDITCH WORCS B98 9HH ENGLAND
+44 (0)1527 583200
+44 (0)1527 584177
Fax +44 (0)1527 584177
e-mail thorlux@thorlux.co.uk
Web www.thorlux.com

